



## WE'RE READY

The Oklahoma City Convention Center is here to make every experience as simple as possible. The \$288 million, state-of-the-art facility has been designed specifically to accommodate trade shows, consumer/public shows, conventions, annual meetings, corporate meetings, various types of receptions, and much more.

This center is a total of 500,000 square feet and includes a 200,730 square foot exhibit hall, which is divisible into four halls; a versatile 29,874 square foot ballroom with 5,000 square foot pre-function space and terrace overlooking Scissortail Park and nearly 45,000 square feet of meeting space; and a 9,726 square foot junior ballroom. There is over 65,000 square feet of pre-function space.

The new venue features glass walls, making use of natural light with breathtaking views of Scissortail Park. Narduli's "Virtual Sky" graces the glass atriums facing Scissortail Park across the street. The artwork evokes Oklahoma's beautiful skies and the state's links to aviation history.

Slender, sleek titanium forms are suspended by aircraft cables in each of the two multi-story atriums facing west across Robinson Avenue. The gleaming forms capture the natural light pouring in across the downtown skyline.



**OKLAHOMA CITY**  
CONVENTION CENTER



ROOM 101



ROOM 102



EXHIBIT HALL



COFFEE SHOP



CONCESSIONS



100 Mick Cornett Dr.  
Oklahoma City, OK 73109

(405) 768-4040  
info@okc-cc.com

1<sup>ST</sup> LEVEL



  
**OKLAHOMA CITY**  
CONVENTION CENTER

[OKC-CC.COM](http://OKC-CC.COM)

# MAKE THE MOST OF YOUR EXHIBIT BOOTH

The Oklahoma City Convention Center offers 200,730 square feet of exhibit and event space. Divisible into a maximum of four individual halls that can operate independently, each individual hall ranges in size from 47,000 to 58,000 square feet. All halls have a ceiling height of 30 feet. The exhibit hall space offers the perfect canvas for a trade show, convention, product launch or general session.

## LEVEL 1 EXHIBIT HALL

ROOM	SQ FOOT.	DIMENSIONS	CLASSROOM	THEATER	BANQUET	10x10 BOOTHS
Hall A	47,067	310' x 149' - 10"	1,368	2,639	1,470	244
Hall B	47,765	310' x 149' - 8"	1,216	2,327	1,140	254
Hall C	47,758	310' x 148' - 5"	1,216	2,163	1,140	260
Hall D	58,140	310' x 184' - 10' 1/8"	1,748	3,367	1,900	309
Halls ABCD	200,730	310' x 632' 1/8"	7,448	13,018	7,980	1046

\*The above recommended capacities can be increased (Fire Marshal approval may be required) or decreased, based upon event requirements (staging, audio visual, and equipment needs).

## DETAILS

- Exhibit hall is 200,730 continuous sq. ft on ground level.
- The space is divisible into 4 halls with 4 roll up garage doors and 2 ramps that have truck access onto the exhibit floor (access by Exhibit Halls A & C).
- Column spacing in the Exhibit Halls are 86' between each column. Fully equipped floor boxes for electrical, communications, data, and plumbing needs.
- 4 permanent concession stands (Big City Barbeque, Bricktown Deli Co., Fire Bros. Pizza Kitchen, El Charo Tex-Mex Grill) offering made-to-order and grab-and-go options.
- 1 coffee outlet (The Café)

## LEVEL 1 MEETING ROOMS

ROOM	SQ FOOT.	DIMENSIONS	CLASSROOM	THEATER	BANQUET	CEILING HEIGHT
Meeting Room 101	1,159	39' - 11 5/16" x 32' - 11"	30	52	40	16'
Meeting Room 102	630	17' - 6 11/16" x 35' - 2"	16	30	20	12'
Meeting Room 103	1,062	30' x 34' - 10 1/4"	32	60	40	12'
Meeting Room 104	1,370	47' - 6 1/2" x 27' - 3 3/4"	56	76	60	16'
Meeting Room 105	1,372	47' - 6 1/2" x 27' - 4"	56	76	60	16'
Meeting Room 106	1,482	47' - 6 1/2" x 30' - 7/8"	54	83	60	16'

\*The above recommended capacities can be increased (Fire Marshal approval may be required) or decreased, based upon event requirements (staging, audio visual, and equipment needs).





ROOM 208



ROOM 201



PUBLIC WORK POD



100 Mick Cornett Dr.  
Oklahoma City, OK 73109

(405) 768-4040  
info@okc-cc.com

2<sup>ND</sup> LEVEL



**OKLAHOMA CITY**  
CONVENTION CENTER

**OKC-CC.COM**

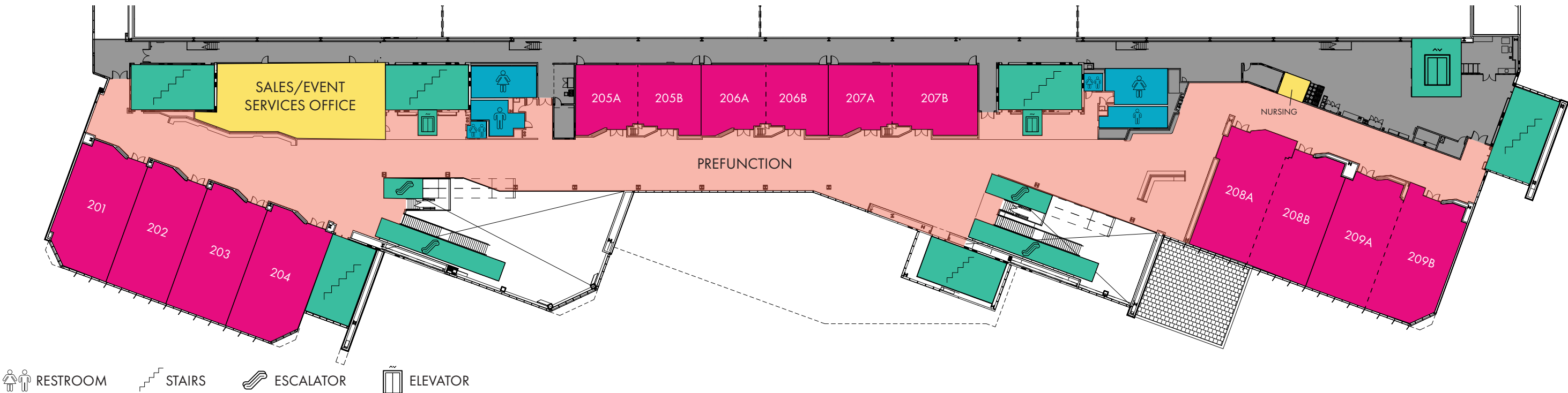

LEVEL 2 MEETING ROOMS

ROOM	SQ FOOT.	DIMENSIONS	CLASSROOM	THEATER	BANQUET
Meeting Room 201	1,905	57' - 10" x 30' - 10 1/2"	58	117	80
Meeting Room 202	1,745	57' - 10" x 29' - 1 1/2"	58	96	80
Meeting Room 203	1,745	57' - 10" x 29' - 1 1/2"	58	96	80
Meeting Room 204	1,792	57' - 10" x 32' - 10 5/8"	58	108	80
Meeting Room 205A	920	29' - 8 1/4" x 29' - 3 3/4"	32	81	40
Meeting Room 205B	920	30' - 3/4" x 29' - 3 3/4"	32	81	40
Meeting Room 206A	920	29' - 8 1/4" x 29' - 3 3/4"	32	81	40
Meeting Room 206B	920	30' - 7/8" x 29' - 3 3/4"	32	81	40
Meeting Room 207A	920	29' - 8 1/4" x 29' - 3 3/4"	58	81	40
Meeting Room 207B	1,275	30' - 7/8" x 39' - 11 1/4"	48	102	40
Meeting Room 208A	1,698	58' - 6" x 31' - 2 5/16"	62	92	80
Meeting Room 208B	1,743	58' - 6" x 29' - 3 13/16"	62	105	80
Meeting Room 209A	1,751	58' - 6" x 29' - 3 11/16"	62	105	80
Meeting Room 209B	1,788	58' - 6" x 30' - 3 13/16"	56	112	80

\*The above recommended capacities can be increased (Fire Marshal approval may be required) or decreased, based upon event requirements (staging, audio visual, and equipment needs).



JUNIOR BALLROOM



100 Mick Cornett Dr.  
Oklahoma City, OK 73109

(405) 768-4040  
info@okc-cc.com

3<sup>RD</sup> LEVEL



OKLAHOMA CITY  
CONVENTION CENTER

OKC-CC.COM

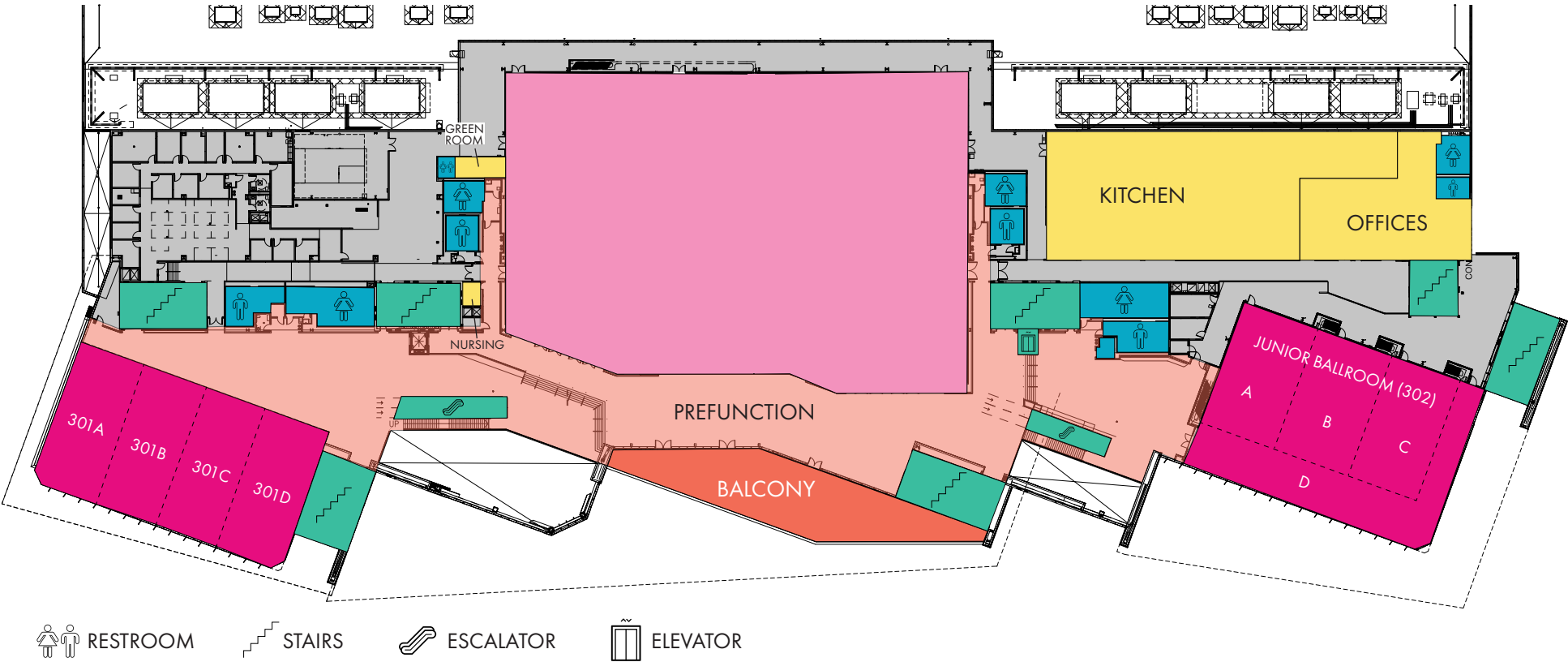

LEVEL 3 MEETING ROOMS

ROOM	SQ FOOT.	DIMENSIONS	CLASSROOM	THEATER	BANQUET
Meeting Room 301A	2,030	63' - 5" x 31' - 5 1/8"	66	134	80
Meeting Room 301B	1,877	63' - 5" x 29' - 7 3/8"	72	122	80
Meeting Room 301C	1,877	63' - 5" x 29' - 7 3/8"	72	122	80
Meeting Room 301D	1,987	63' - 5" x 31' - 1 5/8"	62	123	80
Meeting Room 301A-D	7,771	63'5" x 121' 8"	286	527	320
Meeting Room 301AB	3,907	63'5" X 61 1/2" - 121' 9 1/2"	136	278	160
Meeting Room 301CD	3,754	63'5" X 60' - 9"	134	267	160
Meeting Room 302A	2,224	59' - 6 15/16" x 36' - 4 3/16"	90	143	100
Meeting Room 302B	2,230	59' - 6 15/16" x 35' - 11 7/8"	90	143	100
Meeting Room 302C	2,070	59' - 6 15/16" x 33' - 3 7/8"	72	121	80
Meeting Room 302A-C	6,524	59' 6' X 105' - 11' 15/16	196	426	280
Meeting Room 302A-D	9,726	80' 6 1/4" X 121'	280	664	400

\*The above recommended capacities can be increased (Fire Marshal approval may be required) or decreased, based upon event requirements (staging, audio visual, and equipment needs).

- DETAILS
- 8 meeting rooms totaling 15,897 sq. ft. ranging from 1,877 to 3,202 sq. ft.
  - Junior Ballroom expands to 9,726 sq. ft.
  - Each meeting space has assisted listening device capabilities and an adjustable lighting system.
  - Filter shades and black out shades in rooms with park view.





TERRACE



100 Mick Cornett Dr.  
Oklahoma City, OK 73109

(405) 768-4040  
info@okc-cc.com



4<sup>TH</sup> LEVEL



**OKLAHOMA CITY**  
CONVENTION CENTER

**OKC-CC.COM**



# BALLROOM

The two ballrooms combined add up to a 29,874 square foot event space with 25'6" ceilings. The ballrooms can seat up to 1,300 people for a banquet and 1,820 for a theater. Each ballroom can be broken up into classrooms, theater, and banquet areas. The ballroom includes 5,000 square feet of pre-function space and a 3,956 square foot terrace overlooking 70-acre Scissortail Park.

LEVEL 4 BALLROOMS

ROOM	SQ FOOT.	DIMENSIONS	CLASSROOM	THEATER	BANQUET
Ballroom A 1/2	15,497	136' - 5 1/4" x 115' - 9 7/16"	520	991	580
Ballroom B 1/2	14,377	146' - 4 1/2" x 99' - 2 15/16"	456	900	530
Ballroom A 1/3	7,931	136' - 5 1/4" x 61' - 9 7/16"	230	484	300
Ballroom B 2/3	21,920	146' - 4 1/2" x 153' - 2 15/16"	654	1,296	950
Ballroom A & B	29,874	282' 9 3/4" x 215' 3/8"	908	1,820	1,300

\*The above recommended capacities can be increased (Fire Marshal approval may be required) or decreased, based upon event requirements (staging, audio visual, and equipment needs).

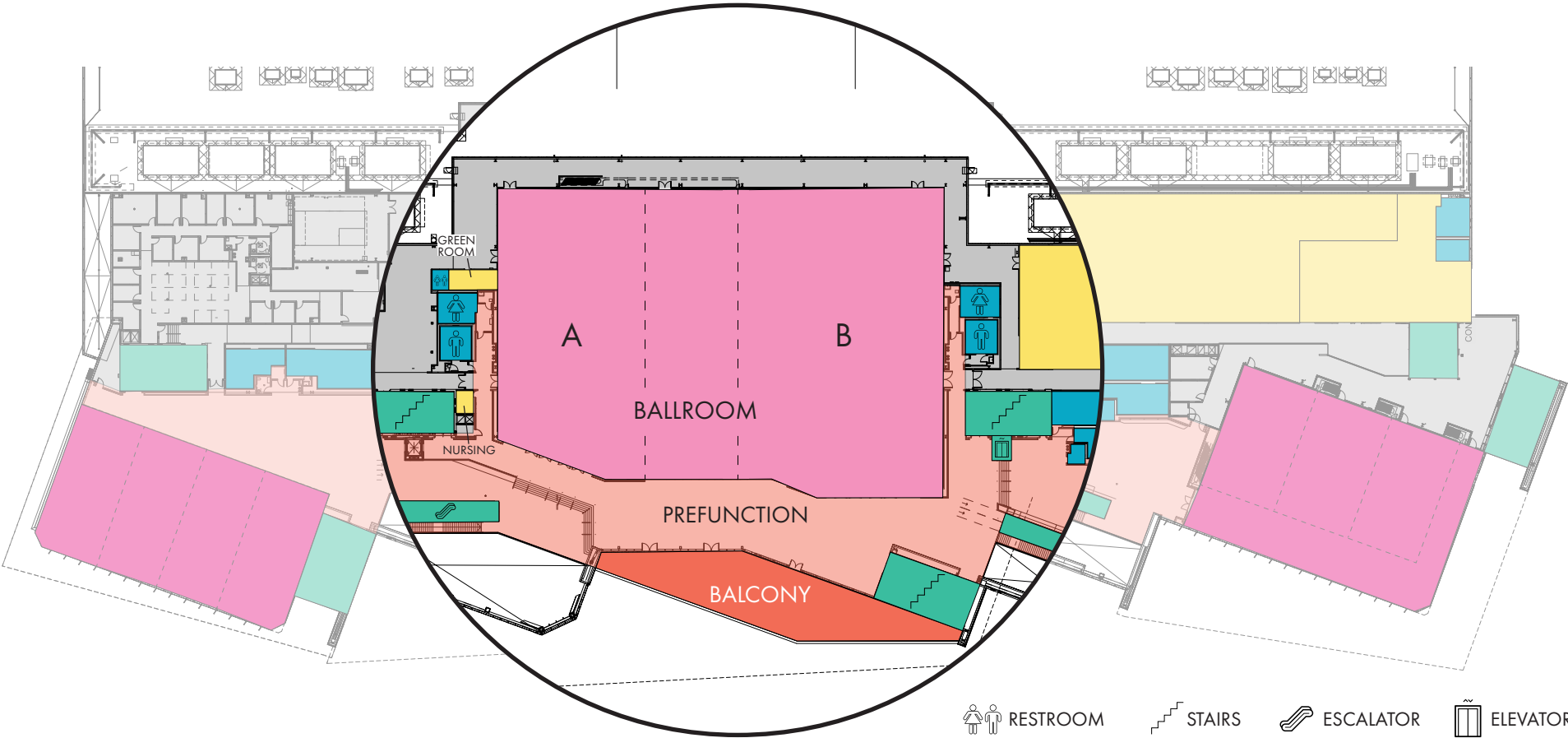

# HOW TO GET HERE



100 Mick Cornett Dr.  
Oklahoma City, OK 73109

(405) 768-4040  
info@okc-cc.com

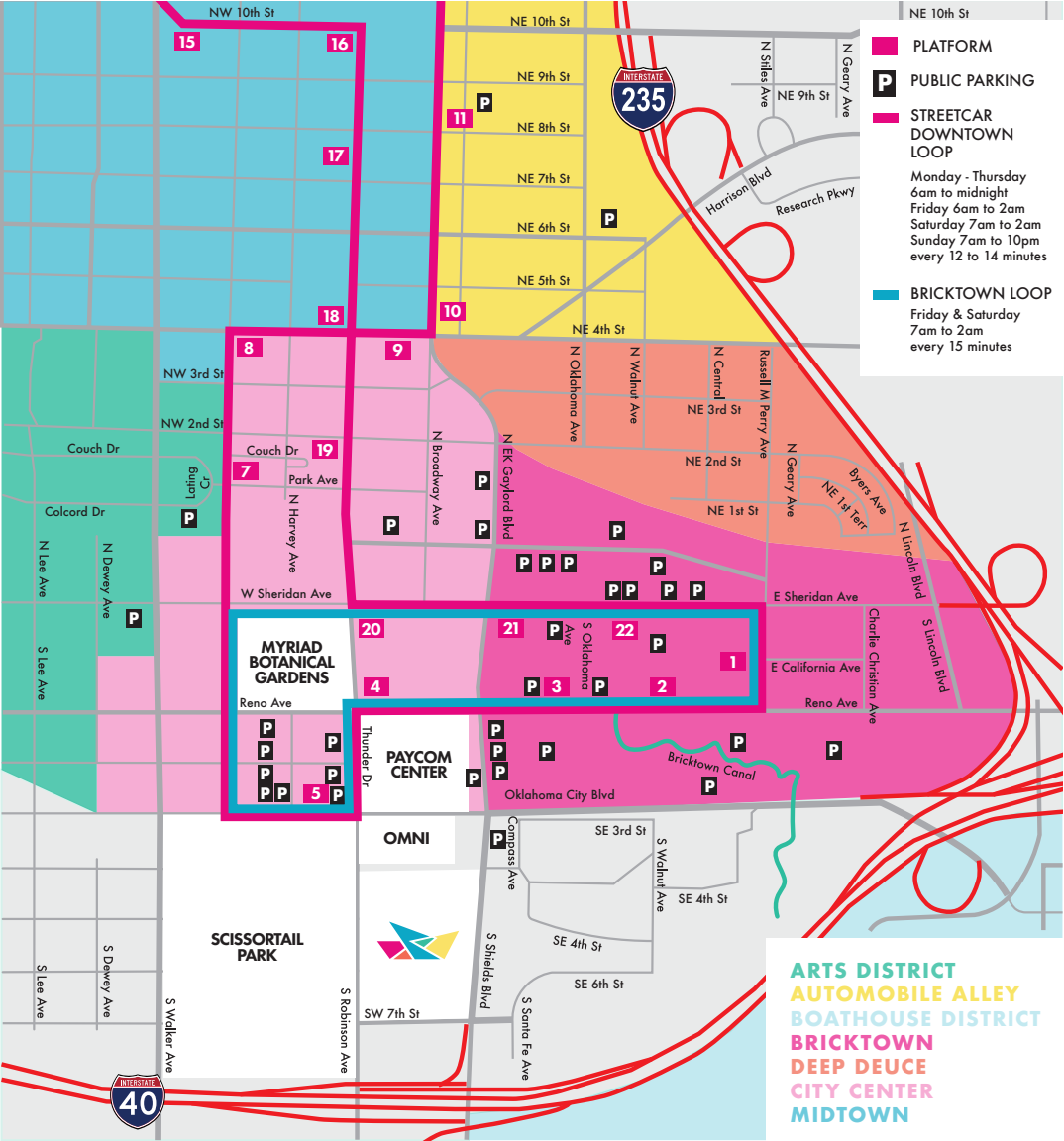

# OVERVIEW



## ABOUT US

### ASM GLOBAL

ASM Global is the world's largest and most trusted venue management and services company, spanning five continents, with more than 300 of the world's most prestigious arenas, stadiums, convention and exhibition centers, and performing arts venues. Our venues connect people through the unique power of live experiences.

### HEALTH & SAFETY

VenueShield is a protocol to provide advanced hygienic safeguards that serve clients, guests and staff. Needlepoint Bipolar Ionization (NPBI) technology delivers purified indoor air. LightStrike Robots are deployed to deactivate pathogens and bacteria that are linked to COVID-19. All policies will be aligned with - and informed by - public health authorities, medical and industry experts.

## TECHNOLOGY

Over 6,000 ft of single-mode fiber 184 access points delivering Wi-Fi across the entire facility. Maximum bandwidth of 20GB/s. The Oklahoma City Convention Center has two Public /24 networks DAS that supports all four major cellular carriers (AT&T, U.S. Cellular, T-Mobile, and Verizon).

### AV SERVICES

The Oklahoma City Convention Center offers many in-house audio visual services. Encore Global is able to provide for most production and rigging services supporting conventions, trade shows, meetings, and live events.

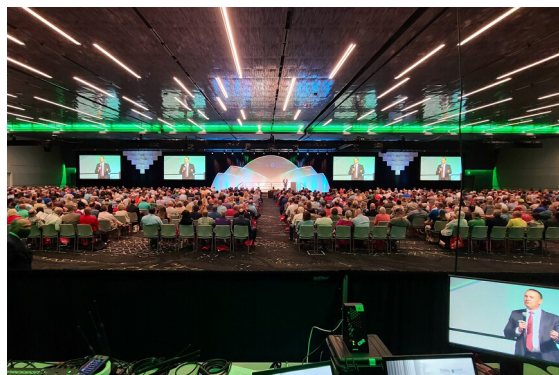

## CATERING

### SAVOR...

Catering • Concessions • Special Events

SAVOR is the exclusive provider of food and beverage service at the Oklahoma City Convention Center. SAVOR offers customized full-service catering with specializations in weddings, receptions, plated and buffet style banquets. SAVOR runs four permanent specialty themed concession stands and The Café Coffee Shop each with contactless ordering that includes made-to-order and grab-n-go items.

Please visit our website

**[okc-cc.com/savorasmglobal](https://okc-cc.com/savorasmglobal)**

to view our catering menu and for more information.





100 Mick Cornett Dr.  
Oklahoma City, OK 73109

(405) 768-4040  
[info@okc-cc.com](mailto:info@okc-cc.com)